

# Re-imagining Albertopolis

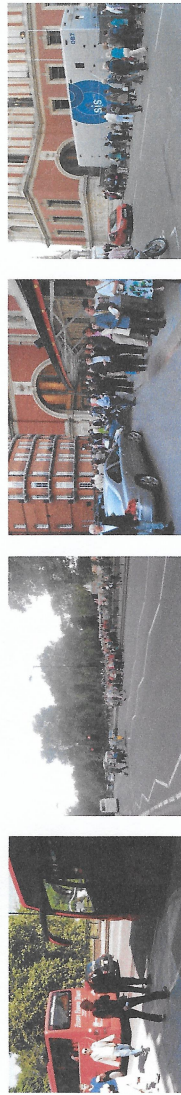

Aerial view of proposed public realm, showing improvements to crossing, park entrance & the environs of the RAH



Current Challenges: Unglorified visitor experience, inadequate crossing facilities that are not fully accessible, major conflict between pedestrians and vehicles and difficulties managing functional requirements

## How important do you think investment in improving the public realm in the area is?

The area around Albertopolis has seen major interventions over the last decade. These include key investments such as the Exhibition Road and the Albertopolis project. The area is now looking lively, and with increasing numbers of visitors, workers and residents, the area is in real danger of becoming a major disappointment. A significant investment in the public realm is needed to ensure the neighbourhood functions well again for all.

The Re-imagining Albertopolis project is intended to transform the area of public realm around the Royal Albert Hall and Albert Memorial, improving the visitor experience, road safety and the appearance of this important part of central London.

The interventions focus around four aspects:

- **Better accessibility and space for pedestrians** - a new, fully-accessible pedestrian crossing across Kensington Gore is proposed that will eliminate the double kerb condition on the park side, reconnecting the northern part of Albertopolis with Kensington Gardens.
- **Highways improvements** - by narrowing Kensington Gore, removing barriers and improving the balance between pedestrians and traffic, the proposals will lead to greater safety on the south side of Kensington Gore.
- **Realignment of the Park** - the proposal will create a wider pavement on the north side of Kensington Gore, returning dignity and ceremony to the setting of the Memorial.
- **A re-imagined landscape** - through the re-landscaping and re-grading of the entrance to the park, a gently sloping, step-free route can be provided into Kensington Gardens.

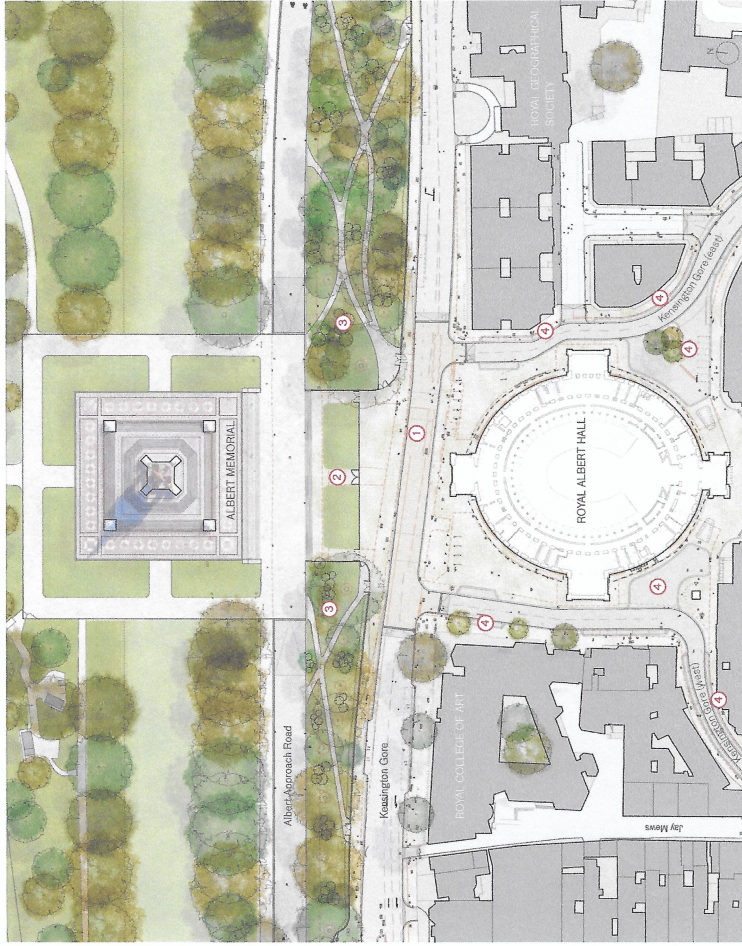

Proposed plan showing scheme overview

- 1 Road narrowing and bus lane changes
  - 2 Adjustment of steps and lawn area
  - 3 Adjustment of paths
  - 4 Provision of parking area
- Yoristone Paving
  - Granite Sals to tonally match Yoristone
  - Resin Bound Gravel
  - Granite Kuratstone
  - Asphalt with coloured topping
  - Asphalt
  - 2m radius around existing trees
  - New fence line

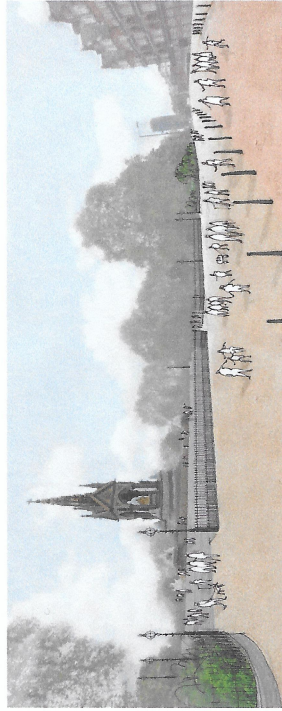

View towards entrances of Kensington Gardens showing new fence line

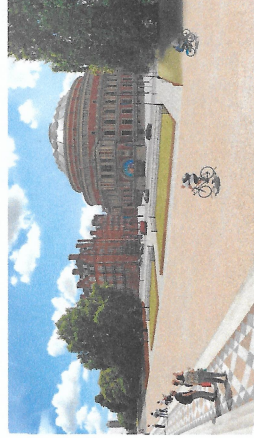

View from the Albert Memorial steps towards the Royal Albert Hall



View from the Albert Memorial steps towards the Royal Albert Hall